

Aspersores Fixos (Spray-Ball)

Padrão	Ø furos	Vazão à 2 Kgf/cm ² (m ³ /h)	Ø Leque (m)
360°	3/32"	16	4
	1/16"	10	3,8
270° superior	3/32"	15	4
	1/16"	9	3,8
270° inferior	3/32"	15	4
	1/16"	9	3,8
180° superior	3/32"	10	3,9
	1/16"	6	3,7
180° inferior	3/32"	8	4,1
	1/16"	5	3,9
150° lateral	3/32"	9	2
150° superior	3/32"	9	4,2
150° inferior	3/32"	12	3,8

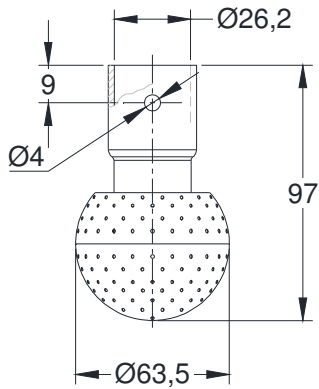

Nota:
Outras distribuições da furação, e Ø do Spray-Ball, disponível sob consulta à "LUINOX".

Ø	A					B
	TC	M RJT	M SMS	M IDF	M DIN	
1"	800	106	95,5	101	103,5	
1½"						
2"						
2½"						
3"						

Adaptadores para Spray-ball

Nota:
Poderão ser fabricados adaptadores conforme solicitação.

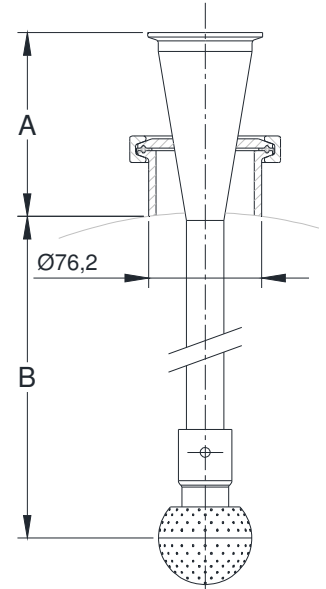

Aspersores Giratórios (Spray-Ball)

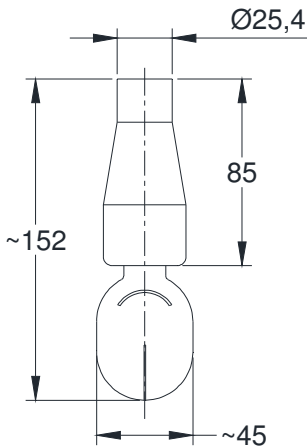

Modelo Solda

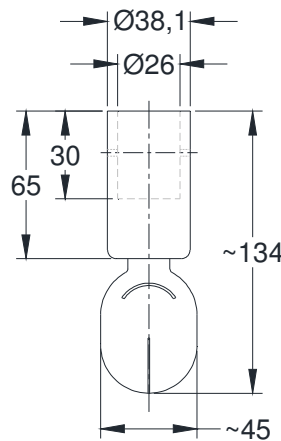

Modelo Clip

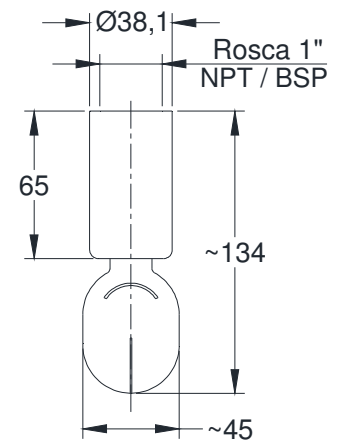

Modelo Rosca

